

Vatican Museums Musei Vaticani

Vatican—Musei Vaticani
Rome/Roma

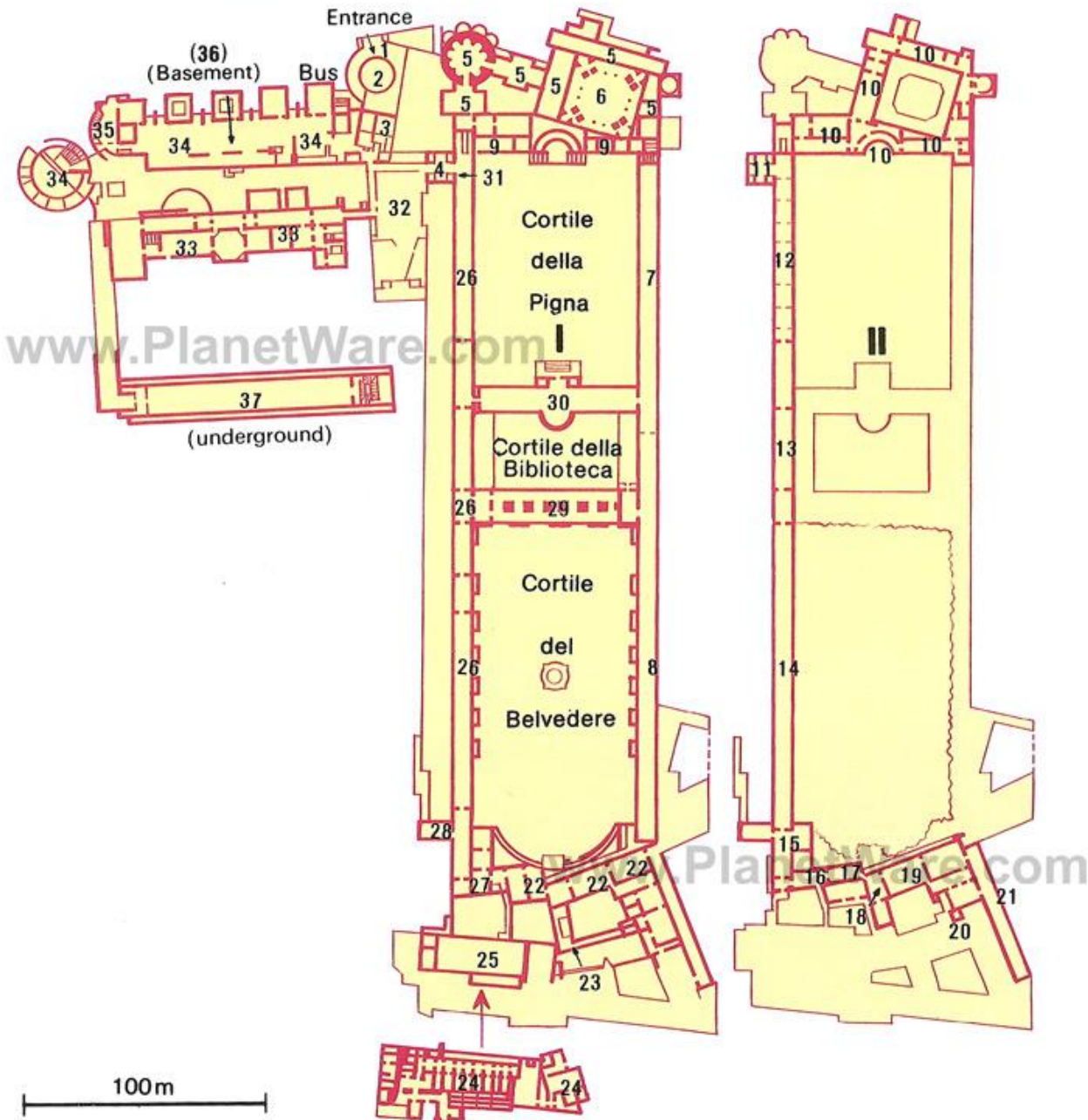

- | | | |
|-----------------------------------------------|-------------------------------------------------------------------------|-----------------------------------------------------|
| 1 Lift | 14 Galleria delle Carte Geografiche (Map Gallery) | 25 Sistine Chapel |
| 2 Stairs | 15 Pius V's Chapel | 26 Vatican Library |
| 3 Vestibule (tickets, information) | 16 Sala Sobieski | 27 Museo Sacro della Biblioteca |
| 4 Atrio dei Quattro Cancelli | 17 Sala dell'Immacolata | 28 Sala delle Nozze Aldobrandine |
| 5 Museo Pio-Clementino | 18 Urban VIII's Chapel | 29 Salone Sistino |
| 6 Cortile Ottagono | 19 Stanze di Raffaello | 30 Braccio Nuovo |
| 7 Museo Chiaramonti | 20 Nicholas V's Chapel (Beato Angelico) | 31 Museo Profano della Biblioteca |
| 8 Galleria Lapidaria | 21 Logge di Raffaello (Loggias of Raphael) | 32 Cortile della Pinacoteca |
| 9 Museo Gregoriano Egizio (Egyptian Museum) | 22 Appartamento Borgia | 33 Pinacoteca (Picture Gallery) |
| 10 Museo Gregoriano Etrusco (Etruscan Museum) | 23 Salette Borgia | 34 Museo Gregoriano Profano (Museum of Secular Art) |
| 11 Sala della Biga | 24 Collezione d'Arte Religiosa Moderna (Museum of Modern Religious Art) | 35 Museo Pio Cristiano |
| 12 Galleria dei Candelabri | | 36 Museo Missionario Etnologico |
| 13 Galleria degli Arazzi (Tapestry Gallery) | | 37 Museo Storico (Historical Museum) |

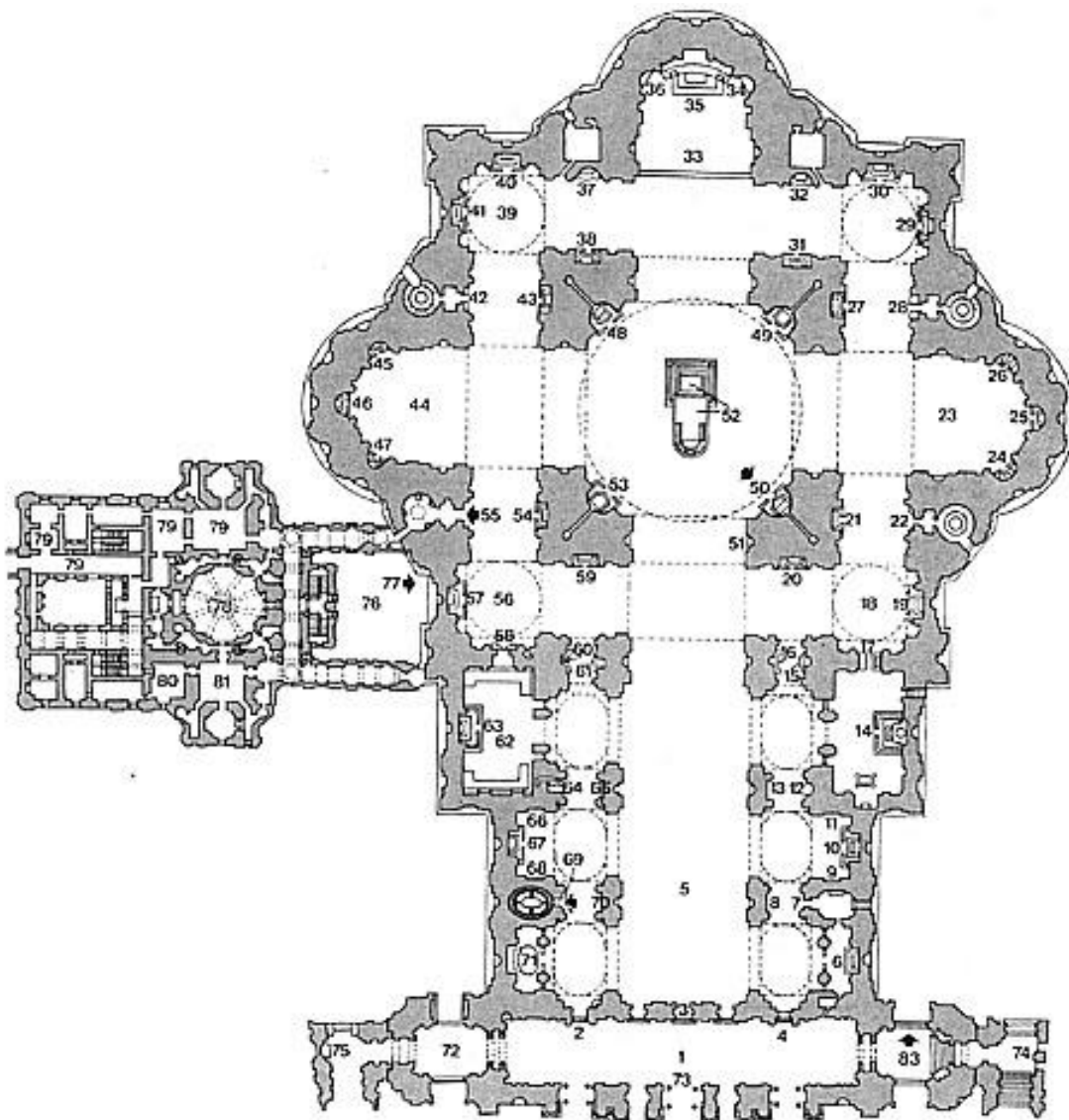

MAP OF ST PETER'S

- | | | |
|--------------------------------------------|--------------------------------------------------------------------------------|---------------------------------------------------------------|
| 1 Atrium | 31 Altar of St Peter and the Resuscitation of Tabitha | 56 Clementine Chapel |
| 2 Door of Death (Porta della Morte) | 32 Monument to Clement X | 57 Altar of St Gregory |
| 3 Central Door (by Filarete) | 33 Nave of St Peter's "Cattedra" | 58 Monument to Pius VII |
| 4 Holy Door (Porta Santa) | 34 Monument to Urban VIII | 59 Altar of the Transfiguration |
| 5 Nave | 35 Throne of St Peter in Glory or "Cattedra" | 60 Monument to Leo XI |
| 6 Chapel of the "Pietà" | 36 Monument to Paul III | 61 Monument to Innocent XI |
| 7 Monument to Leo XII | 37 Monument to Alexander VIII | 62 Chapel of the Choir |
| 8 Monument to Christine of Sweden | 38 Altar of St Peter and the Healing of the Cripple | 63 Altar of the Immaculate Conception |
| 9 Monument to Pius XI | 39 Chapel of Our Lady of the Column | 64 Monument to Pius X |
| 10 Chapel of St Sebastian | 40 Altar of St Leo the Great | 65 Monument to Innocent VIII |
| 11 Monument to Pius XII | 41 Altar of Our Lady of the Column | 66 Monument to John XXIII |
| 12 Monument to Innocent XII | 42 Monument to Alexander VII | 67 Chapel of the Presentation of the Virgin |
| 13 Monument to Mathilda of Canossa | 43 Altar of the Sacred Heart | 68 Monument to Benedict XV |
| 14 Chapel of the Blessed Sacrament | 44 Left Transept | 69 Monument to Maria Clementina Sobieski (exit from the Dome) |
| 15 Monument to Gregory XIII | 45 Altar of St Thomas | 70 Monument to the Stuarts |
| 16 Monument to Gregory XIV | 46 Altar of St Joseph | 71 Baptistery |
| 17 Monument to Gregory XVI | 47 Altar of the Crucifixion of St Peter | 72 Arch of the Bells (Arco delle Campanelle) |
| 18 Gregorian Chapel | 48 Statue of St Veronica | 73 Giotto's mosaic of the "Navicella" |
| 19 Altar of Our Lady of Succour | 49 Statue of St Helena | 74 Equestrian Statue of Constantine |
| 20 Altar of St Jerome | 50 Statue of St Longinus (entrance to the Vatican Grottoes) | 75 Equestrian Statue of Charlemagne |
| 21 Altar of St Basil | 51 Statue of St Peter | 76 Braschi Square |
| 22 Monument to Benedict XIV | 52 Confession and Papal Altar | 77 Entrance to the Pre-Constantinian Necropolis |
| 23 Right Transept | 53 Statue of St Andrew | 78 Sacristy |
| 24 Altar of St Wenceslas | 54 Altar of Falsehood | 79 Historical-Artistic Museum (Treasury) |
| 25 Altar of Saints Processus and Martinian | 55 Monument to Pius VIII (entrance to Sacristy and Historical-Artistic Museum) | 80 Chapter Hall |
| 26 Altar of St Erasmus | | 81 Chapel of the Canon |
| 27 Altar of the "Navicella" | | 82 Chapel of the Beneficed |
| 28 Monument to Clement XIII | | 83 Entrance to the Dome |
| 29 Altar of the Archangel Michael | | |
| 30 Altar of St Petronilla | | |

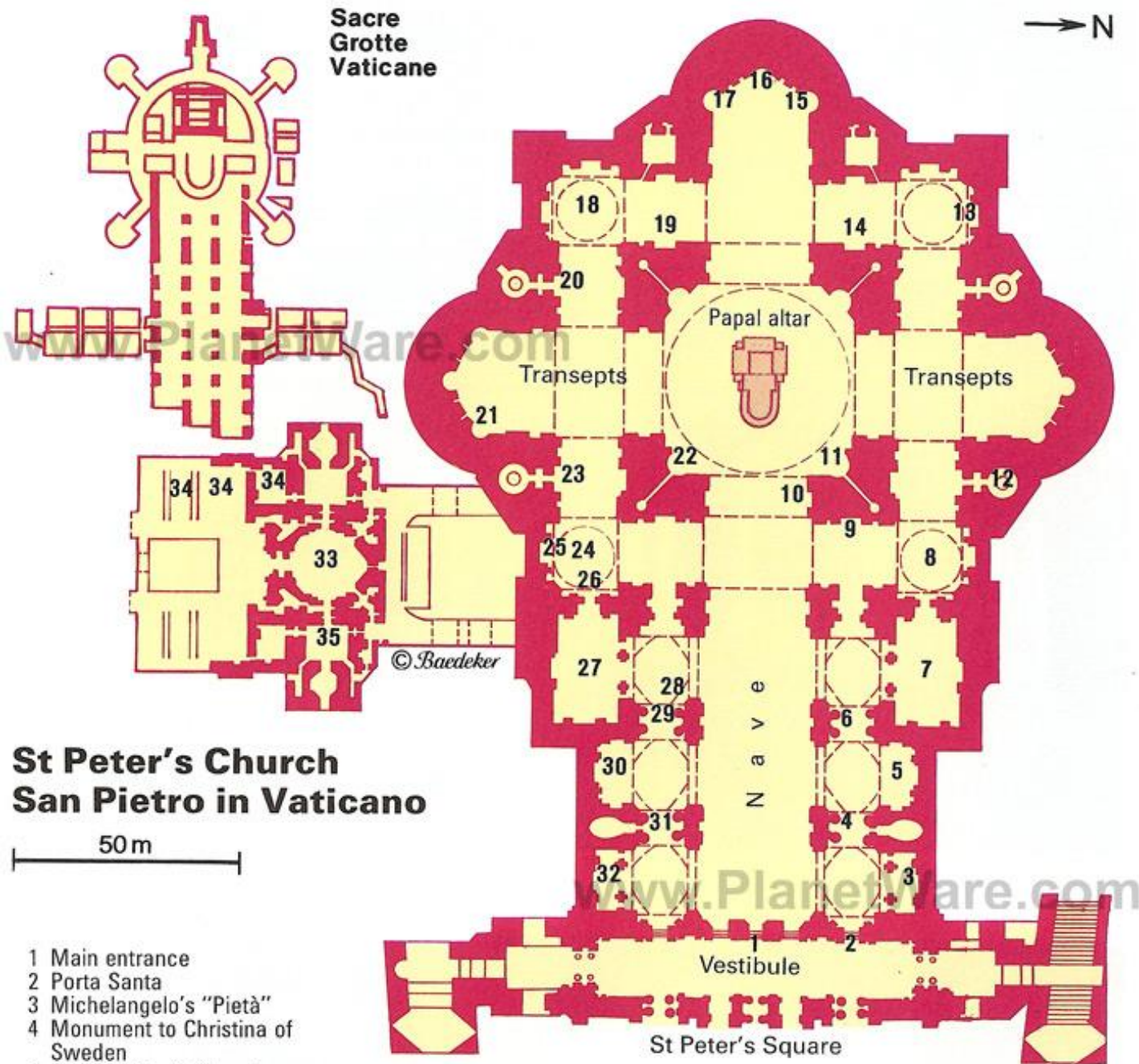

**St Peter's Church
San Pietro in Vaticano**

50m

- | | | |
|----------------------------------------------------------------------------------------------------------------------------------------------------------------------------------------------------------------------------------------------------------------------------------------------------------------------------------------------------------------------------------------------------------------------------------------------------------------------------------------------------------------------------------------------------------------------|----------------------------------------------------------------------------------------------------------------------------------------------------------------------------------------------------------------------------------------------------------------------------------------------------------------------------------------------------------------------------------------------------------------------------------------|---------------------------------------------------------------------------------------------------------------------------------------------------------------------------------------------------------------------------------------------------------------------------------------------------------------------------------------------------------------------------------------------------------------------------|
| <ul style="list-style-type: none"> 1 Main entrance 2 Porta Santa 3 Michelangelo's "Pietà" 4 Monument to Christina of Sweden 5 St Sebastian's Chapel 6 Monument to Margravine Mathilda of Tuscany 7 Chapel of the Sacrament 8 Gregorian Chapel 9 Altar of St Jerome 10 Statue of St Peter 11 Entrance to Vatican Sacred Grotto 12 Entrance to Dome 13 Altar to Archangel Michael 14 Altar of St Peter (restoring Tabitha to life) | <ul style="list-style-type: none"> 15 Tomb of Pope Urban VIII 16 Cathedral Petri (by Bernini) 17 Tomb of Pope Paul III 18 Chapel of the Column 19 Altar of St Peter (healing the lame man) 20 Tomb of Pope Alexander VII 21 Altar of the Crucifixion of St Peter 22 Statue of St Andrew 23 Tomb of Pope Pius VIII 24 Clementine Chapel | <ul style="list-style-type: none"> 25 Altar of St Gregory 26 Monument to Pope Pius VII 27 Choir Chapel 28 Tomb of Pope Innocent VIII 29 Monument to Pope Pius VII 30 Chapel of the Presentation 31 Monument to Maria Sobieska 32 Baptistry 33 Sacristy 34 Museo Storico Artistico (Treasury) 35 Canons' Sacristy |
|----------------------------------------------------------------------------------------------------------------------------------------------------------------------------------------------------------------------------------------------------------------------------------------------------------------------------------------------------------------------------------------------------------------------------------------------------------------------------------------------------------------------------------------------------------------------|----------------------------------------------------------------------------------------------------------------------------------------------------------------------------------------------------------------------------------------------------------------------------------------------------------------------------------------------------------------------------------------------------------------------------------------|---------------------------------------------------------------------------------------------------------------------------------------------------------------------------------------------------------------------------------------------------------------------------------------------------------------------------------------------------------------------------------------------------------------------------|

Vatican Treasury

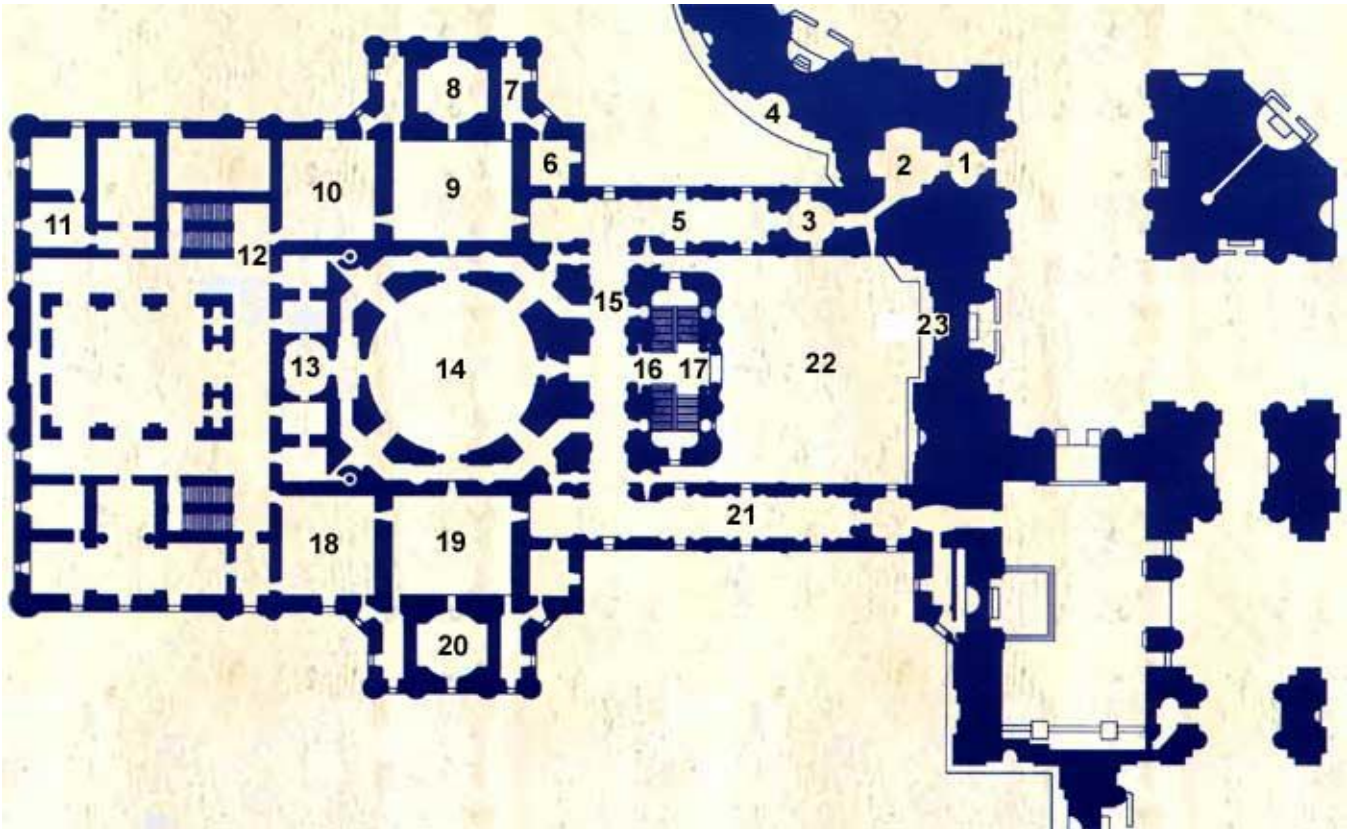

- | | |
|-------------------------------------------|---------------------------------------------|
| 1. Entrance from the basilica | 13. Chapel of the Sacristy Comune |
| 2. List of Popes Buried in St Peter's | 14. The Sacristy |
| 3. Connecting Room with the Corridor | 15. Corridor to the Sacristy |
| 4. Statue of Josemaria Escriva - Opus Dei | 16. The Staircase of Honor |
| 5. Corridor of the Treasury Museum | 17. Statue of Pius VI |
| 6. Museum Entrance - Gift Shop | 18. The Sala Capitolare |
| 7. Column from Constantinian Basilica | 19. The Sacristy of the Canons |
| 8. Chapel of the Beneficiaries | 20. The Chapel of the Canons |
| 9. Dalmatic of Charlemagne | 21. The Corridor to the Choir |
| 10. Monument of Sixtus IV | 22. Piazza Bracchi |
| 11. Treasury Museum Rooms | 23. Statue of St. María Josefa |
| 12. Sarcophagus of Giunio Basso | (Entrance to Necropolis-Exit from Grottoes) |

In the left aisle, under the monument of Pius VIII, is the entrance to the sacristy. It is a building which was attached to the basilica under Pius VI who commissioned Carlo Marchionni (1702-1786) to build it in 1776. On the right of the entrance, is a list of the popes buried in St. Peter's and a statue of St. Andrew in polychrome marble, and then a gallery, decorated with columns of the rarest marbles and bronze busts of Benedict XIII and Paul IV by Agostino Penna. The main Sacristy, which is octagonal, is decorated with eight columns from Hadrian's Villa in Tivoli.

From the sacristy, the ten rooms which house the Treasury can be visited. Worthy of note are: the fourth-century twisted marble column, decorated with vine tendrils; the gilded-medal cock, which formerly adorned the bell tower of old St. Peter's; the Chair of St. Peter, a copy of the oak throne which Charles the Bald presented to Pope John VIII in 875; the Dalmatic, said to have belonged to Charlemagne, but which is in fact an 11th century Byzantine masterpiece; the red cope and the tiara embellished with precious stones, which are put on the statue of St. Peter in the central nave for important solemnities; the Stuart chalice; the Crux Vaticana, made of leather studded with silver and precious stones and which contains fragments of the cross of Jesus; numerous reliquaries and valuable candelabra; a plaster cast of Michelangelo's Pieta made in 1934-35, thanks to which it was possible to restore the original perfectly after it was vandalized in 1972; the funerary monument of Sixtus IV, founder of the Sistine Chapel and the Apostolic Library, sculpted by Antonio del Pollaiuolo. One of the most important sources of documentation of the art and faith of Christians in first-century Rome is the Sarcophagus of Junio Bassus, a noble and prefect of Rome, and a convert to Christianity. The marble sarcophagus, a fourth-century work, is carved with reliefs showing scenes from the Old and New Testaments.